

## Heatsinks for Power LEDs

**KHS500**



### KHS500

- ▶ High efficiency
- ▶ Most applications where a compact light source is required

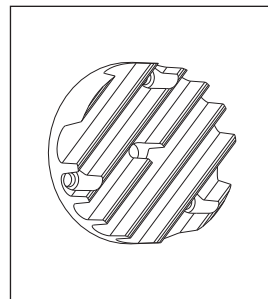

**Part Number**

**KHS 500**

**LED type**

Power LEDs 1W / 3W

### Technical data:

- $R_{th} (^{\circ}C/W) = 10,3^{\circ}C/W$
- $W/mK = 193 - 200$  (Therm comd.)
- Material: Aluminium ALMgSi0,5  
UNI 6060 DIN 1725
- $Kg/dm^3 = 2,7$  (Spec. gravity)

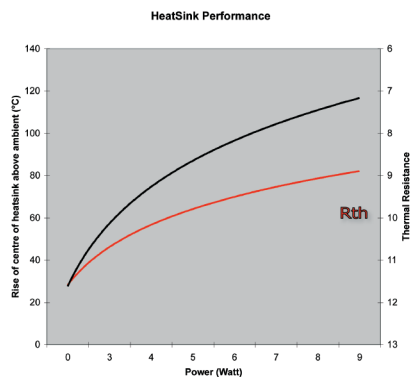

For further information visit our web site: [www.khatod.com](http://www.khatod.com)

